



**941055 Brake Lathe Toolbox**  
**941054 Side Storage Cabinet**  
**941053 Lighted Toolboard**

## **Assembly Instructions *with Parts Identification***

READ these instructions before placing unit in service. KEEP these and other materials delivered with the unit in a binder near the machine for ease of reference by supervisors and operators.

***HENNESSY INDUSTRIES, INC.***

1601 J. P. Hennessy Drive, LaVergne, TN USA 37086 615/641-7533 800/688-6359

HENNESSY INDUSTRIES INC. Manufacturer of AMMCO®, COATS® and BADA® Automotive Service Equipment and Tools.

Manual Part No.: 341205 00

Revision: 07/02

# Brake Lathes

## When You Receive Your Cabinet

Unpack the cabinet parts and check them against the parts list on the last page of this manual. Make sure you have all the parts listed – and the quantities listed. Report any shortages immediately.

## #941055 Brake Lathe Toolbox

### Preparing the Bench for Use

1. Carefully lay the bench on its side.
2. Screw a leveling foot into the threaded hole located at each corner of the bench (4 locations).
3. Once the bench is placed in its final location, level the bench by raising or lowering the 4 leveling feet as necessary.
4. Insert a plastic cap in all of the bench top holes that will not be used for your lathe.
5. Attach lathe to bench.
6. Attach the funnel to the 2 holes in the top of the left end panel. Use 2 truss head screws.



Figure – Attach Funnel

7. Place drawer liners in the four drawers.

## #941054 Side Storage Cabinet

### Preparing the Cabinet for Use

1. Carefully lay the cabinet on its side.
2. Screw a leveling foot into the threaded hole located at each corner of the cabinet (4 locations).
3. Once the cabinet is placed in its final location, level it by raising or lowering the 4 leveling feet as necessary.
4. Place mat on top of cabinet.
5. Place drawer liners in the four drawers.

## #941053 Tool Board and Light Canopy

### Attaching the Tool Board and Light Canopy

1. Use 3 truss head screws to attach each bracket to the rear of cabinet. Wrench tighten.



Figure – Attach Brackets to Cabinet

2. Use 3 truss head screws and 3 flange nuts to attach an upright to the bracket. Wrench tighten the nuts. Repeat for the other bracket and upright.



Figure 2 – Attach Uprights to Brackets

3. Attach left-hand and right-hand canopy gussets to the sides of the uprights using two truss head screws and nuts for each. Wrench tighten.

4. Position the upper tool board behind the front flanges of the uprights with the tool board flange on the top and facing the rear. Secure the tool board to the holes in the uprights with truss head screws and nuts. Hand tighten the nuts only.

5. Fasten light fixture to light panel using screws and nuts supplied with the light. Note that the light attaches to the side of the light panel that has the front edge formed down.

6. Lay light fixture panel assembly on top of gussets with the formed edge pointing downwards at front of cabinet. Secure panel to gussets with four truss head screws and nuts.

7. Fasten the sign to the front of the light canopy with two truss head screws and nuts.

8. Wrench tighten all hardware.

# Brake Lathes

## Parts Identification

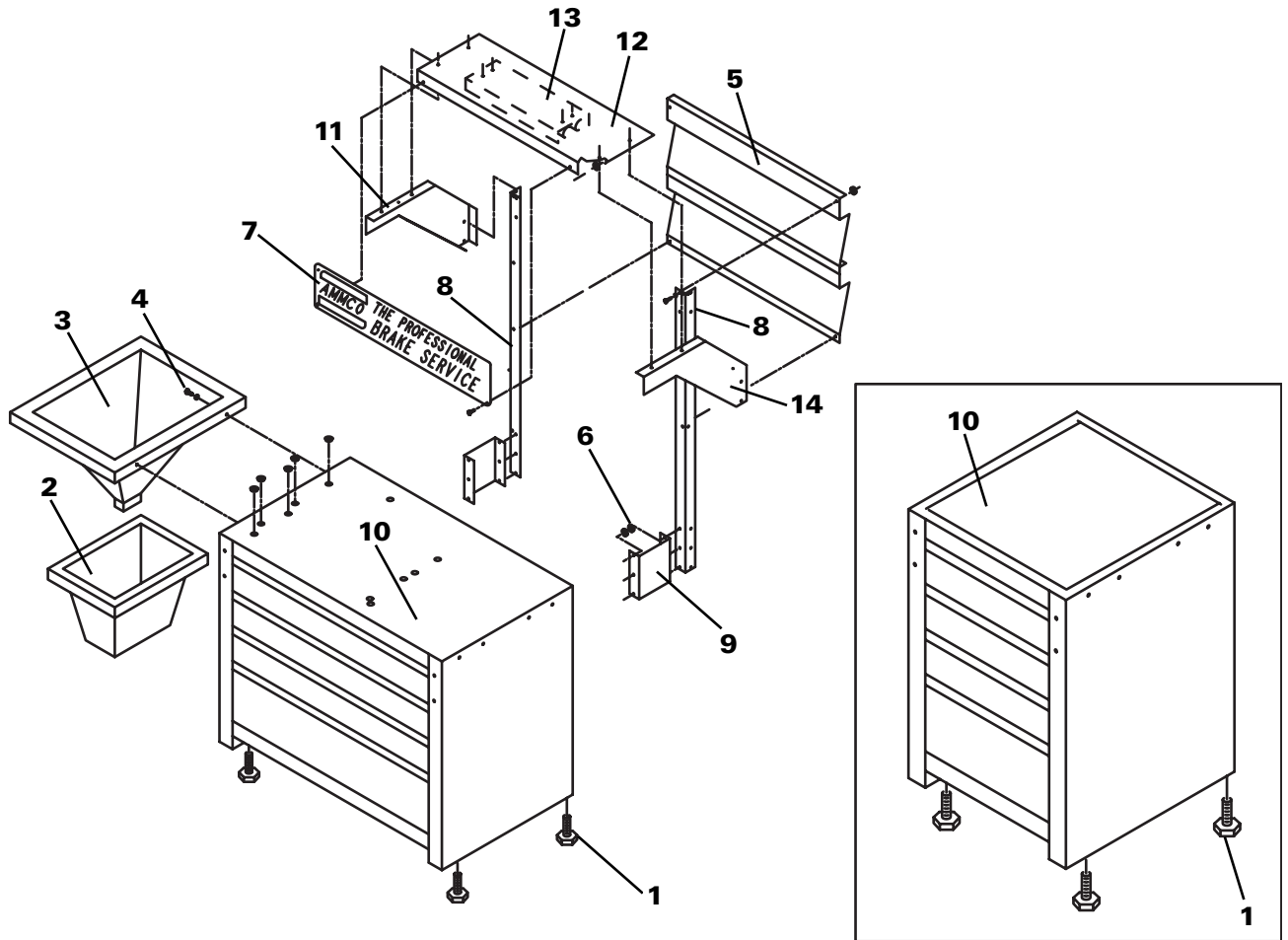

Item	Part	Quantity			Description
		941055	941054	941053	
1	940062	4	4	--	Adjustable Foot
2	923749	1	--	--	Chip Bucket
3	923748	1	--	--	Chip Funnel
4	924100	2	--	28	1/4-20 x 3/4 Truss Head Screw
5	940055	--	--	1	Tool Board, Short
6	924557	--	--	22	1/4-20 Hex Flange Serrated Face Nut
7	925255	--	--	1	Sign
8	941178	--	--	2	Upright
9	941182	--	--	2	Bracket
10	*****	Not Available Separately			Base Weldment
11	941179	--	--	1	Canopy Gusset, LH
12	941180	--	--	1	Light Mounting Fixture
13	941181	--	--	1	Light Fixture
14	941188	--	--	1	Canopy Gusset, RH
*	909966	--	--	15	Storage Hook
*	941186	8	--	--	Top Shelf Cap
*	941185	4	--	--	1/16" Black Drawer Liner
*	941184	--	4	--	1/16" Black Drawer Liner
*	941183	--	1	--	Top Shelf Protector

\*Not Shown

